



I-215 / Holland Road Overpass

CONSTRUCTION ACTIVITIES

LOCATION	ACTIVITIES
1 Holland Rd between Antelope Rd and Hanover Ln	<ul style="list-style-type: none"> Remove vegetation and landscaping.
2 Holland Rd at Haun Rd	<ul style="list-style-type: none"> Relocate a manhole and prepare for other utilities.

ROADWAY RESTRICTIONS

LOCATION	CLOSED	OPEN	TIME/HOURS
1 Holland Rd between Antelope Rd and Hanover Ln	<ul style="list-style-type: none"> Westbound right-turn lane. 	<ul style="list-style-type: none"> Westbound middle lane for right-turn lane and left-turn lane. 	<ul style="list-style-type: none"> January 23-27 6:30am-4pm
2 Holland Rd at Haun Rd	<ul style="list-style-type: none"> Northbound Haun Rd merging lanes. 	<ul style="list-style-type: none"> One in each direction. Open trenches will be plated lanes but may need to remain closed. 	<ul style="list-style-type: none"> January 23-February 24 6:30am-4pm
3 Upcoming Closure: Holland Rd between Antelope Rd and Hanover Ln	<ul style="list-style-type: none"> Holland Rd will be fully CLOSED to allow the contractor to begin removals, roadway and bridge improvements. A separate notice will be issued with additional details. 		<ul style="list-style-type: none"> Week of January 30.

WHAT TO EXPECT DURING CONSTRUCTION

- Motorists can expect traffic delays during the closures.
- Traffic control devices/signage will be placed to direct traffic around the closures.
- Water trucks will be used to maintain dust control during construction.
- Expect to see large equipment and construction noise.
- Drive with caution throughout the project area and allow extra time to reach your destination.
- The schedule is subject to change based on weather, or unexpected events.

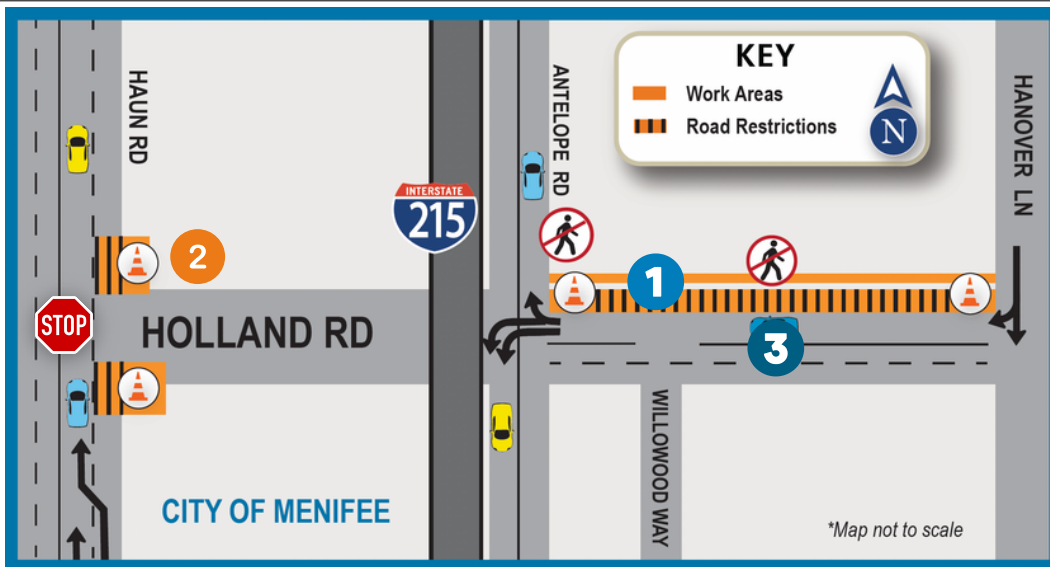

SIGN UP! (951) 200-4146 | info@hollandoverpass.com | hollandoverpass.com

TEXT Updates: Text HOLLAND to 74121 or EMAIL Updates: Text HOLLAND to 22828

